

Kitchen Planning Guide

Customer Info

Full Name: _____

Email: _____

Phone: _____

About Your Space

Ceiling height: _____

Wall cabinet height: _____

Is the ceiling flat or vaulted? _____

Do you want the cabinets to go up to the ceiling with crown molding? Yes No

If not, how high would you like to go? _____

if applicable

Soffit height: _____

Soffit depth: _____

Are there any other limitations?

(plumbing, electric, flooring, etc.) _____

Your New Kitchen

Primary door style & finish: _____

Accent or island door style & finish: _____

Framed Frameless Unsure

[View door styles and finishes here](#)

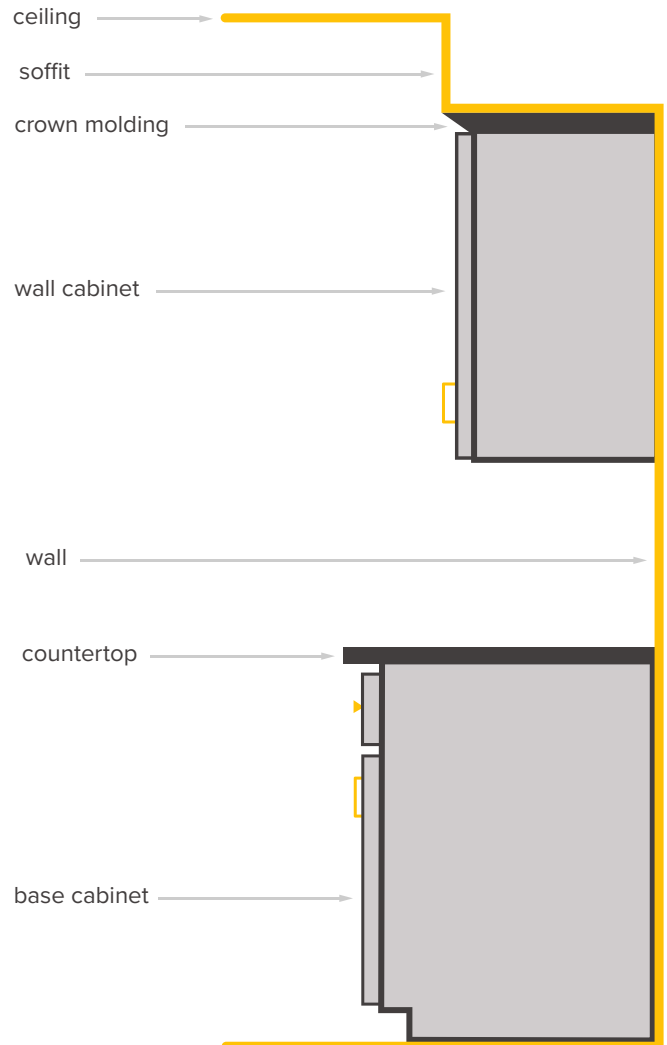

Please check any extras you prefer:

- | | |
|---|---|
| <input type="checkbox"/> Wine Storage | <input type="checkbox"/> Light Rail Molding |
| <input type="checkbox"/> Plate Rack | <input type="checkbox"/> Open Shelves |
| <input type="checkbox"/> Crown Molding | <input type="checkbox"/> Garbage Pull Out Cabinet |
| <input type="checkbox"/> Crown Molding to the Ceiling | <input type="checkbox"/> Spice Pull Out Cabinet |
| <input type="checkbox"/> Roll Out Trays | <input type="checkbox"/> Lazy Susan |
| <input type="checkbox"/> Glass Doors | <input type="checkbox"/> Microwave Upper Cabinet |
| <input type="checkbox"/> Decorative Door Panels | <input type="checkbox"/> Microwave Base Cabinet |
| <input type="checkbox"/> Wood Hood | <input type="checkbox"/> Wide Storage Drawer(s) |
| <input type="checkbox"/> Base Molding | <input type="checkbox"/> Soft Close |
| | <input type="checkbox"/> Cutlery Divider |

Kitchen Planning Guide

Customer Info

Full Name: _____

Drawing Your Floor Plan

Use a pencil and the graph paper attached to design your new kitchen.



How To Measure

Tip

Pick a corner to start. Then measure the full length of the wall. Continue around the whole room.

! Be sure to measure from the outside of the trim edge to the far wall.

! Make sure that all your measurements add up to the overall wall measurement.

Mark all your measurements in inches only, so 7'6" should be marked as 90".



Indicate the direction of the door swing.

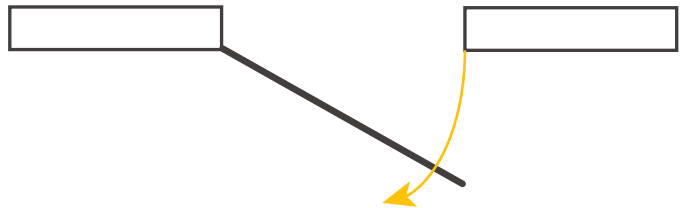

Measure all objects on the wall (windows, doors, electrical outlets, gas lines, ventilation duct work A/C vents).

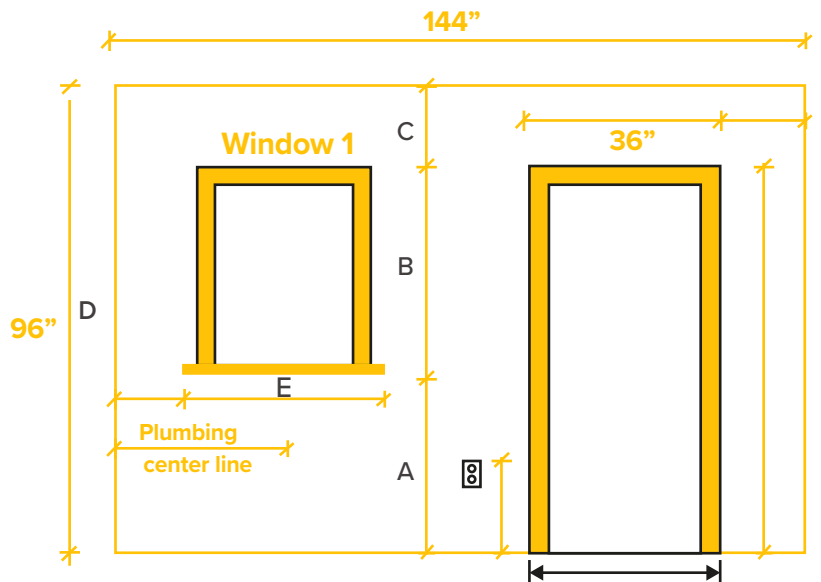

Measure all the window and door openings from outside trim edge to outside trim edge

Window Measurements

Name	Width	Height	Distance From Floor

Kitchen Planning Guide

Customer Info

Full Name:

Transfer all information to the design grid and include actual measurements in inches.

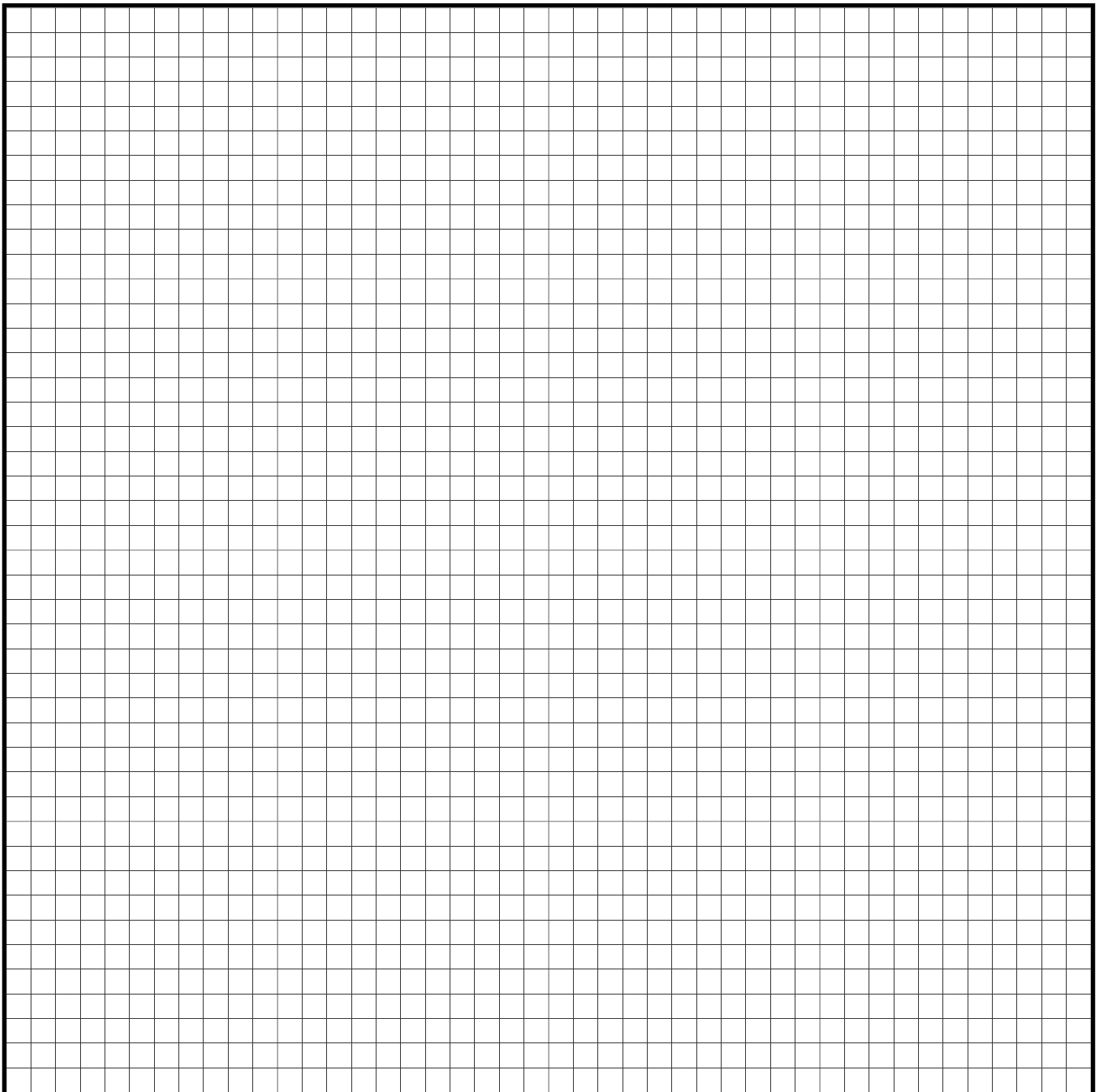

Kitchen Planning Guide

Customer Info

Full Name: _____

In order to do a complete design we will need to know the exact sizes of all the appliances that are going to be used in the new kitchen design. **If you have any Manufacturer Spec Sheets, please include them in your email or fax along with your kitchen planning guide.**



Appliances In Your New Kitchen

Range

Brand/Model	Width	Depth	Height

Cook-top

Brand/Model	Width	Depth	Height

Oven

Brand/Model	Width	Depth	Height

Hood

Brand/Model	Width	Depth	Height

Microwave

Brand/Model	Width	Depth	Height

Refrigerator

Brand/Model	Width	Depth	Height

Dishwasher

Brand/Model	Width	Depth	Height

Other

Brand/Model	Width	Depth	Height

Kitchen Planning Guide

Customer Info

Full Name:

Appliances In Your New Kitchen

If unable to provide model numbers, please answer the following questions:

Counter depth or standard depth appliances?

Cooktop or range?

Over the range:

Stainless steel hood to the ceiling? Yes No

Hood under wall cabinet? Yes No

Wood hood? Yes No

Microwave? Yes No

Double ovens or micro-oven?

If it's a double oven and separate microwave, where would you prefer the microwave?

Sink:

Under-mount or apron front?

Additional Information

Is this project a renovation or new construction?

If new construction, which phase of construction is the project in?

Are the walls up? Yes No

For new construction, we provide an initial design and quote to plan for plumbing, electric, and budget. Walls should be re-measured once in place. Ideally, final revisions will be submitted about 2 weeks before ordering.